

User Story 1:

As a freshman/returning student, I want an easy-to-use map of the campus so that I can find what buildings my classrooms are located in.

Top Ideas:

1.

Detailed campus map with 3D buildings

2.

Map that is just a wireframe of the buildings on which the user can zoom

Map that tells me where are the building entrances

Add a 3D button that allows the user to see height of buildings to help them navigate the campus better

Map that includes landmarks that are not buildings like trees

Amenity list for each building

Icons to indicate buildings features such as whether they have shelters for severe weather.

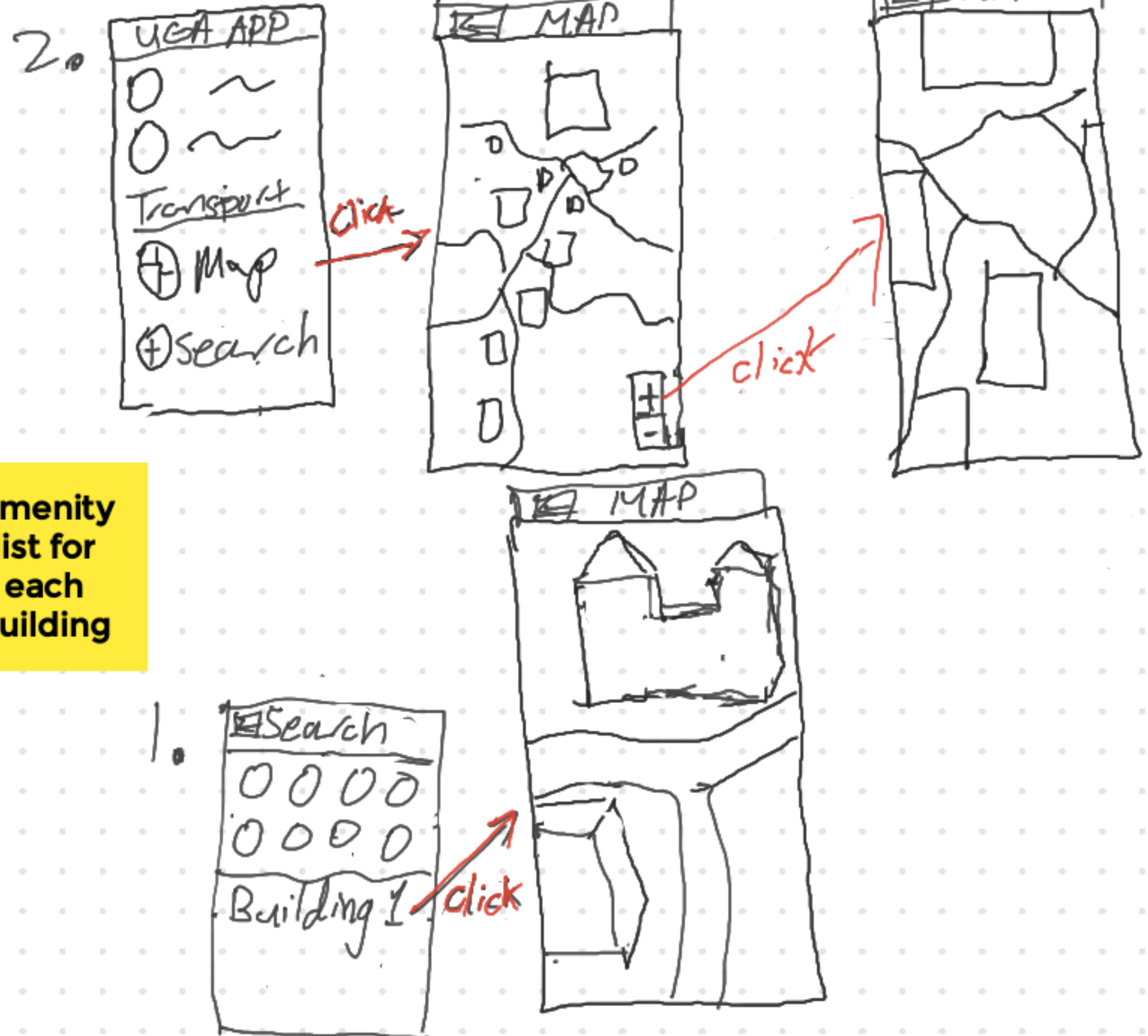

2.



click



click



1.

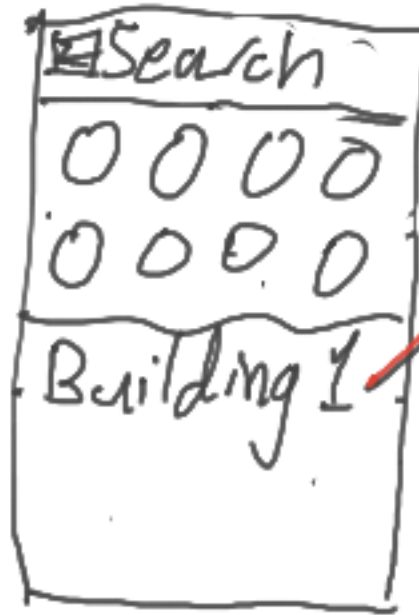

click



User Story 2:

As a Student or Faculty Member of the university, I want a digital indoor building map that has all the room numbers, restrooms, stairs, entrances, etc. so that I can locate rooms within academic buildings on campus without having to frantically find the room inside the building.

Top Ideas:

1.

A map that has an icon for the target classroom

2.



A map with all the room numbers labeled so the user can look at the nearby room numbers to help them navigate

Map with indoor tornado shelter locations in the building

Dedicated map for each building, accessed from list of buildings

A map with no rooms labeled. The user navigates based on an icon on the map that indicates where they are

Indoor map that is zoom-able

Dedicated map for each building, accessed from map that shows all buildings

Indoor map with restroom locations

A map that shows the route from the selected entrance to the target classroom

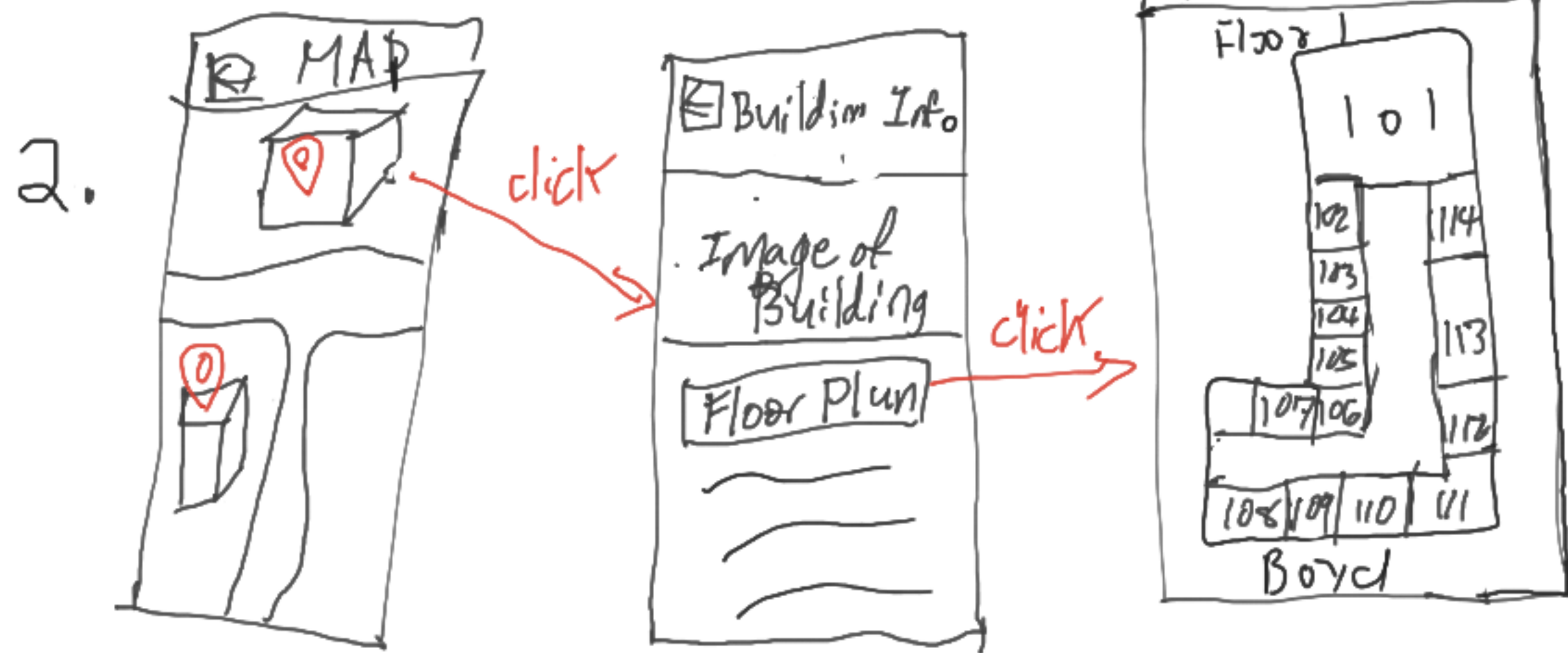
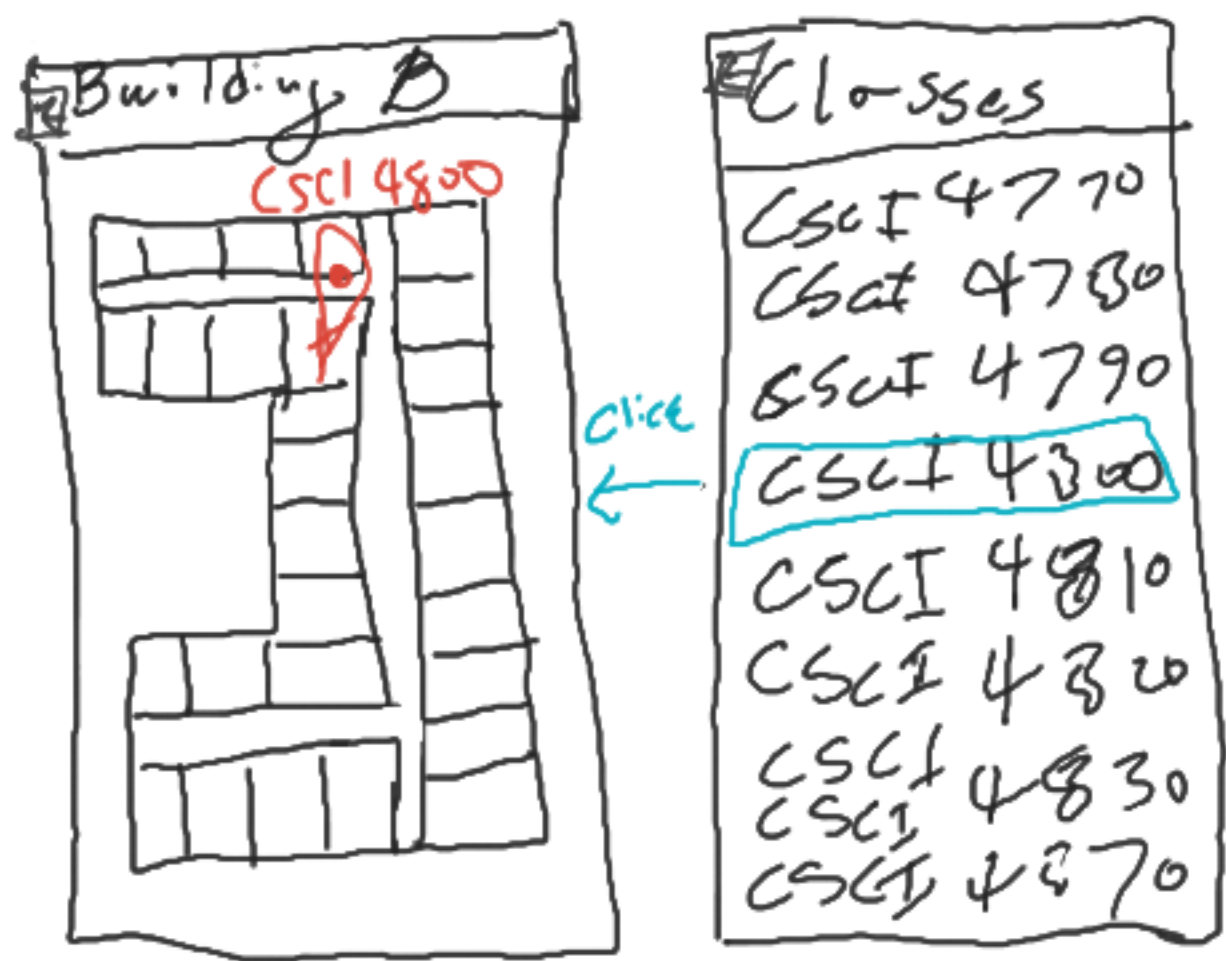

User Story 3:

As a new student or faculty member of the university, I want to be able to view the indoor building map for each of the floors in a particular building so that it is easier to navigate within a building and find a particular room.

Top Ideas

1.  Map that allows you to swap between seeing each entire floor at the press of a button in the corner

2.  Map that shows building floors spread out so you can see everything at once

Have a gallery of the maps for each of the floor when the user selects a building

A button with list of floors

A clearly labeled sidebar that allows the user to select the floor that they are interested in seeing, reducing on-screen clutter

Maps for different floors

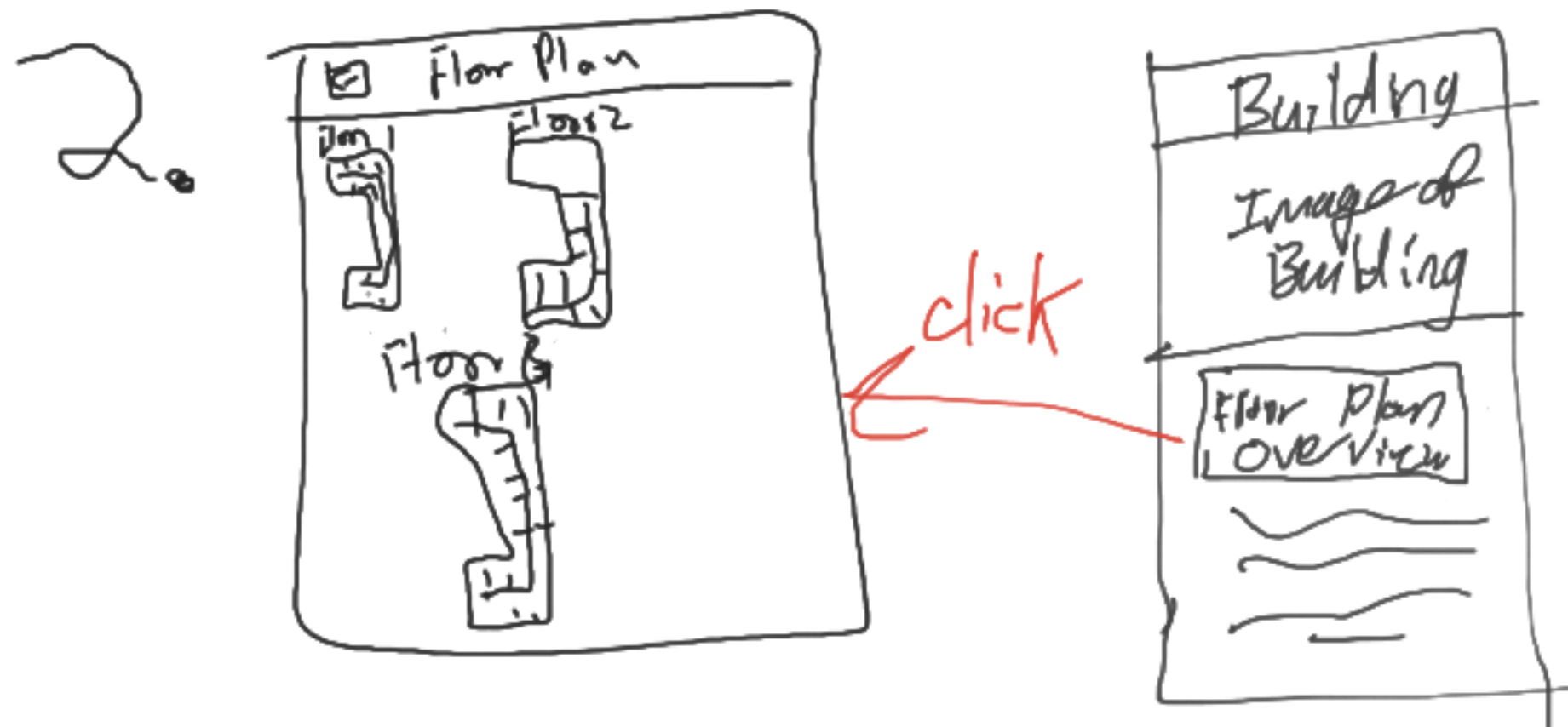
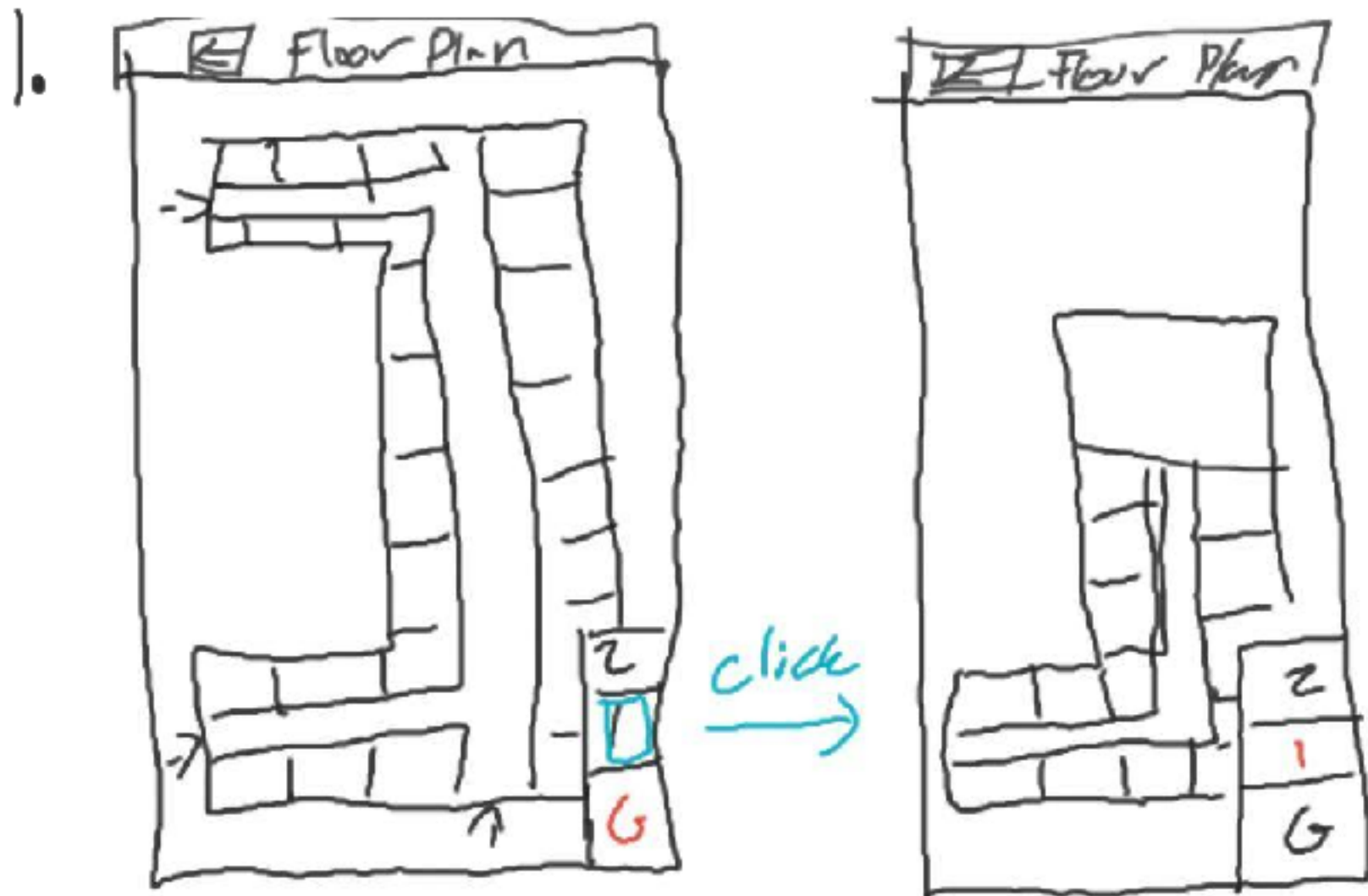

User Story 4:

As a student, I want an easy-to-understand list of bus routes and their route directions as well as their stops so that I know which bus I should take to arrive at my desired destination.

Top Ideas

1.

Improve signifiers to reach a list of bus stops that are sorted by distance from user (already implemented, but hard to get to)

2.

Click on bus stops to expand details showing which routes stop there and the future stops of each of the routes

3.

A combination of ideas 1 and 2



Full route names rather than one or two-letter abbreviations

Improved bus route lines so that it is easier to tell bus routes apart if the user has multiple routes active.

Checkbox list for route selection should be labeled to make it clear that the checkboxes refer to bus routes

Allow users to expand specific routes in the selection pane to get more details about them and what stops they make

If a specific destination has been set by the user, highlight the routes which will be most useful to the user to reach that location

List buses alphabetically

List buses based on how full they are

List the buses based on how often this specific user utilizes each bus

Use a line of arrows instead of a solid line to clearly indicate what direction that a bus route is going in, so that it is obvious what stop that bus will go to next at first glance.

List buses based on time it will take to get to destination riding them (factoring in fullness and time till nearest bus stop)

List the buses based on how commonly they are used by the student population as a whole

List buses based on time it will take for the user to get on it (factoring in user's distance from current location to nearest bus stop and time for the bus to arrive)

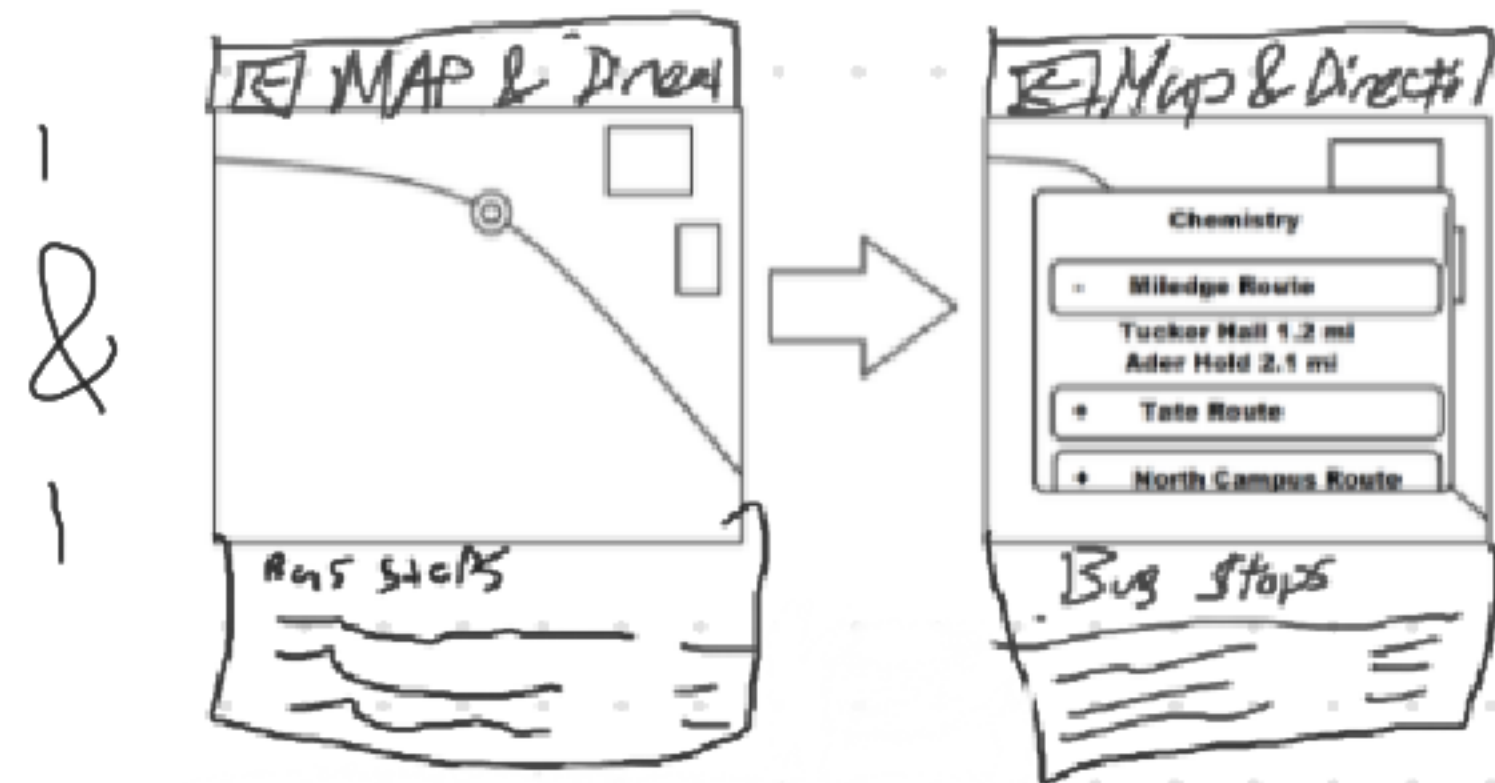
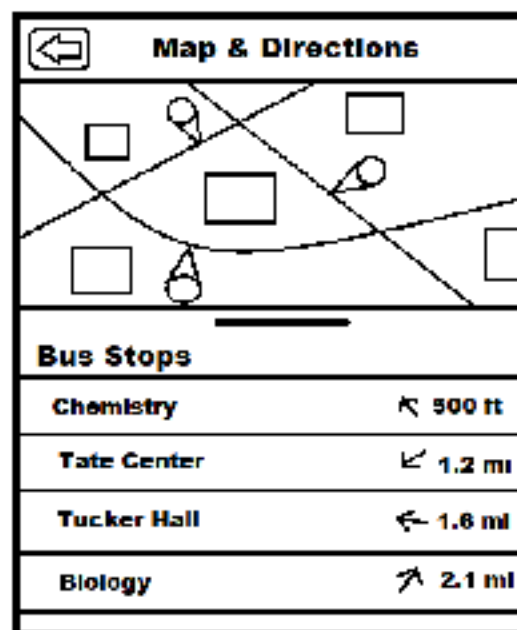
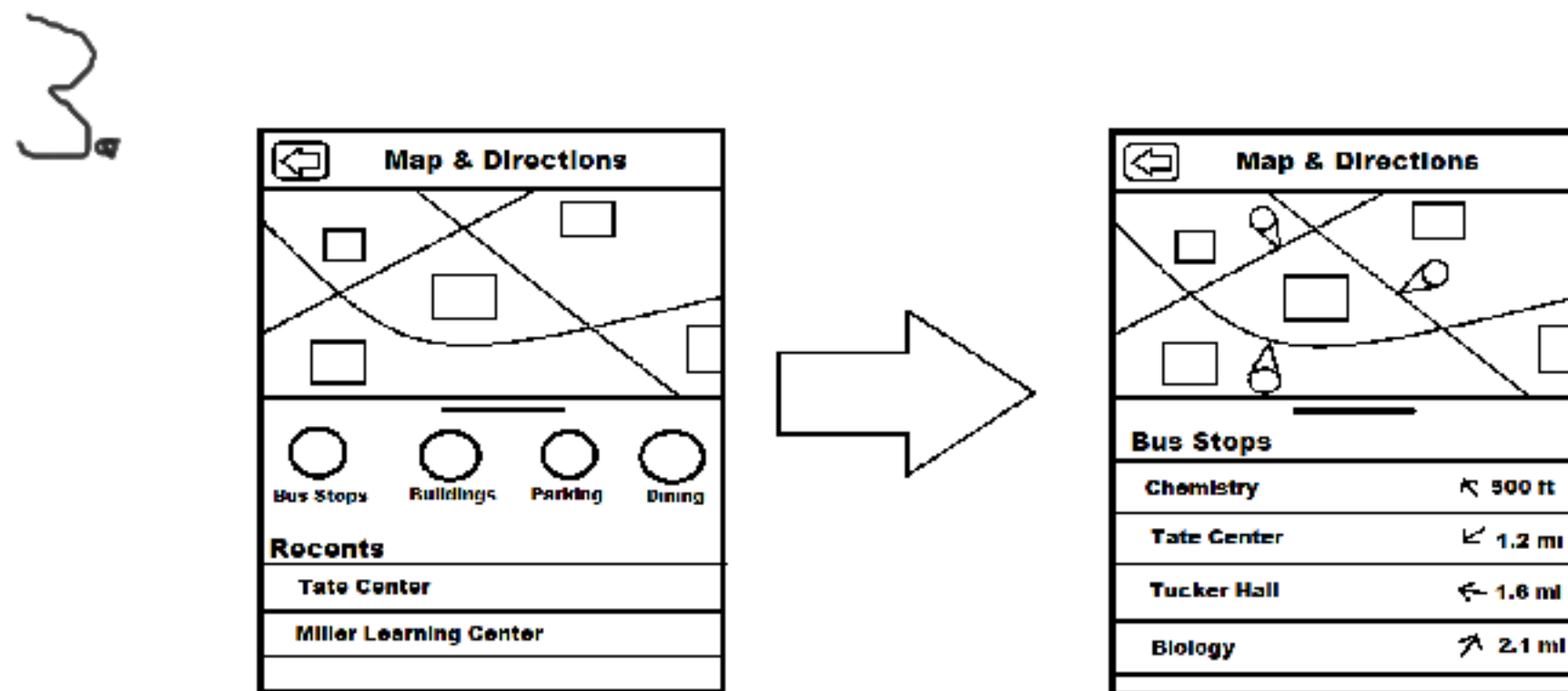
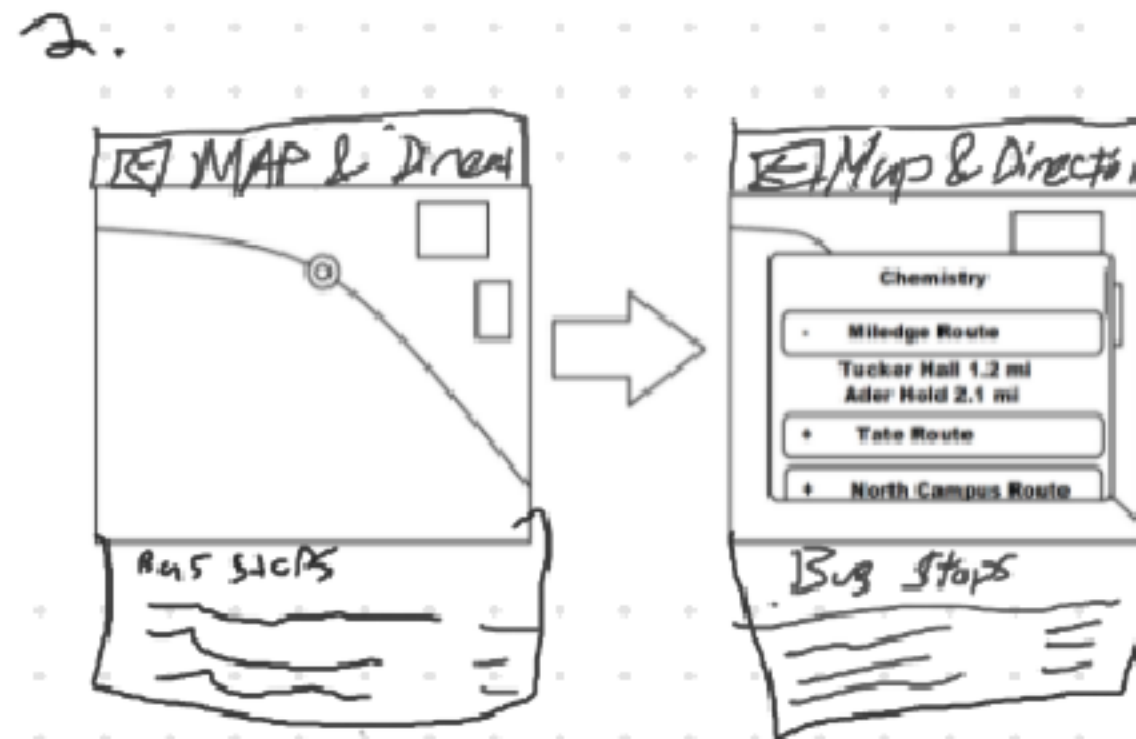
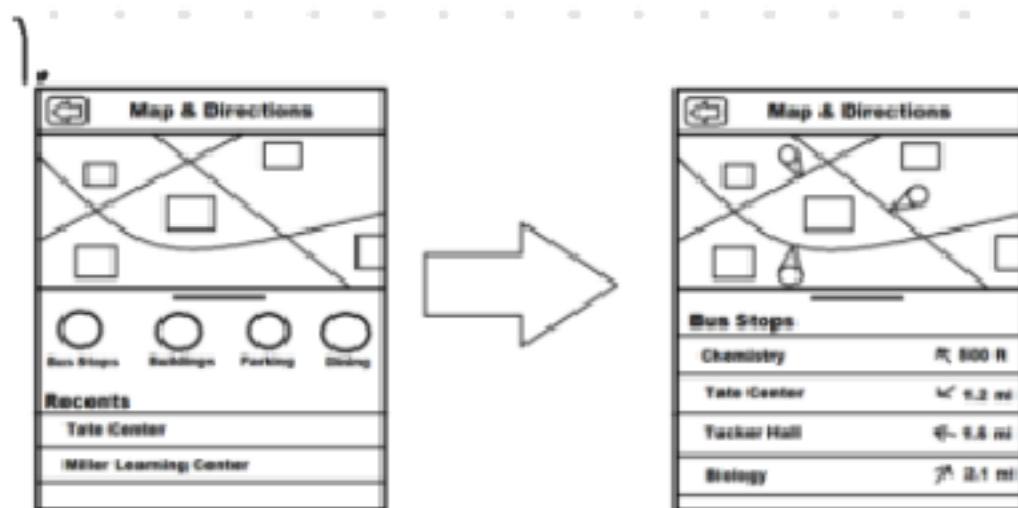

User Story 5:

As a student, I want to know the specific bus information in the app like how many people are on the bus, bus ID, and bus status (out-of-service) so that I can make an informed decision as to whether to take the bus or walk to my next class.

Top Ideas

1.

Display Driver status, whether the driver is on break, occupancy, bus ID, electric or not

2.

Add additional details for buses that give the bus capacity and if the driver is on break. If a bus is going out of service, change the icon on the map and mention it in the bus details.

An indicator to tell the occupancy level on the bus

Display Bus ID so that I can identify the bus on the map

List estimated bus arrival times

An indicator for whether a bus is out of service or not.

An icon when selecting a bus to indicate whether the bus is electric or non-electric

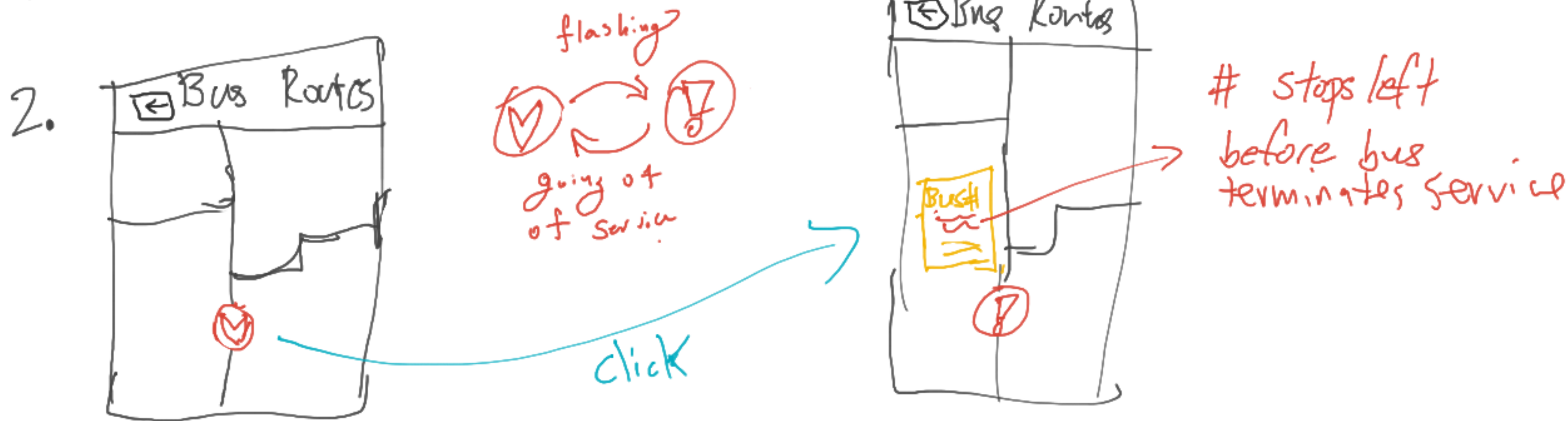
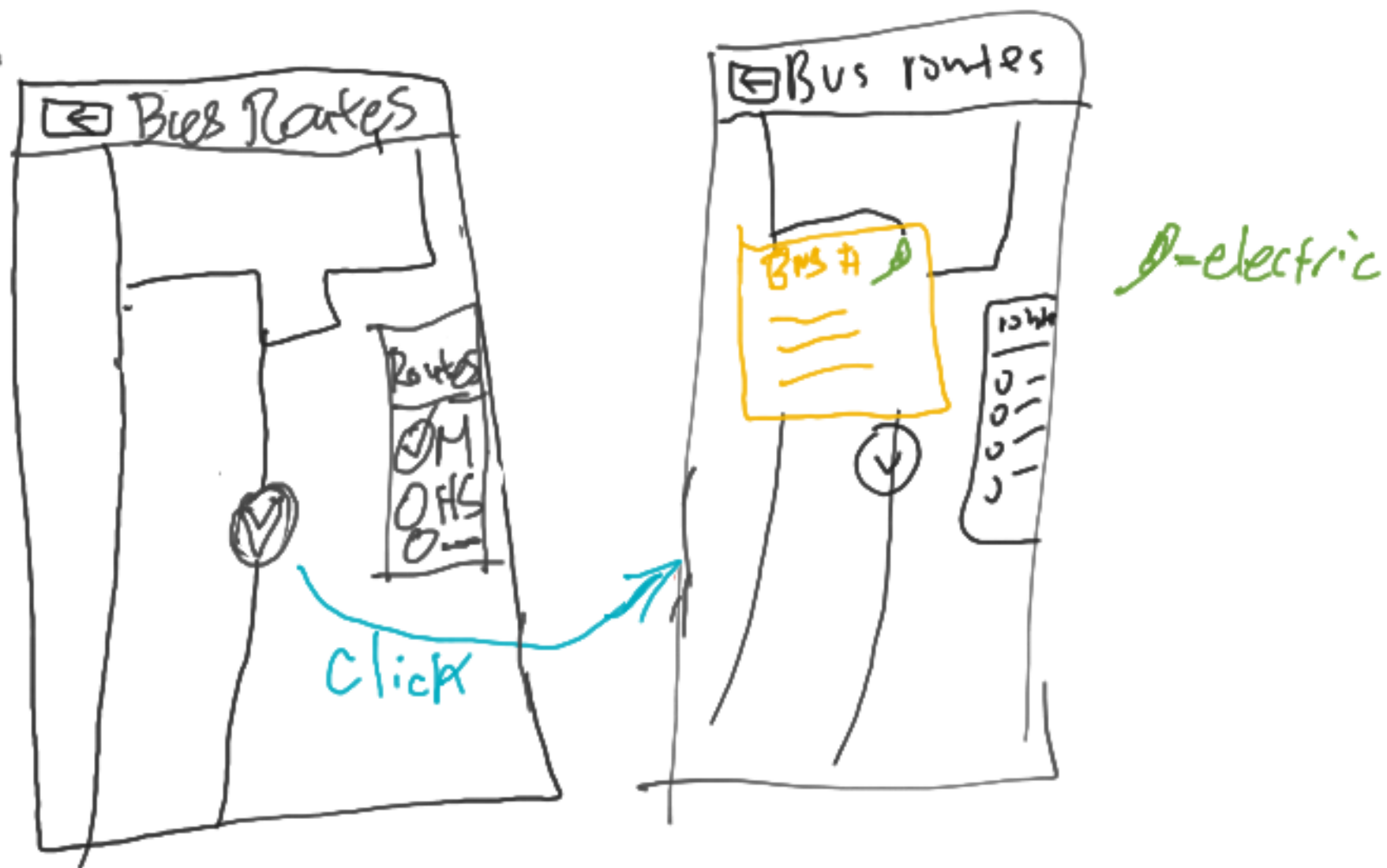

User Story 6:

As a student or faculty member of the university, I want an in-app navigation system which provides me with fusion routes to my destination with time estimates so that I can combine multiple modes of transport to reach my destination as quickly as possible.

Top Ideas

1. The user can enter a destination and check the transport options they want the system to use when calculating directions (essentially all routes use hybrid option). The opinions are saved.

2. Allow users with certain disabilities to specify alternative transport methods to incorporate in routing such as UGA's Paratransit system

3. A combination of ideas 1 and 2

If walking directions are selected, the system should always provide the user walking directions to/from applicable bus stops in reaching their destination

Allow the user to specify certain disabilities which may impact the routes or transport modes that the user can use

Incorporate traffic conditions and live bus tracking in calculating the optimal route

If the user selects the Hybrid option for directions, calculate the most optimal route using all available methods of transport

Add a button to the directions page that allows the user to select method of transport: Walking, Bus, Driving, or Hybrid

When selecting the hybrid route, prompt the user to select the transport methods they would like to use

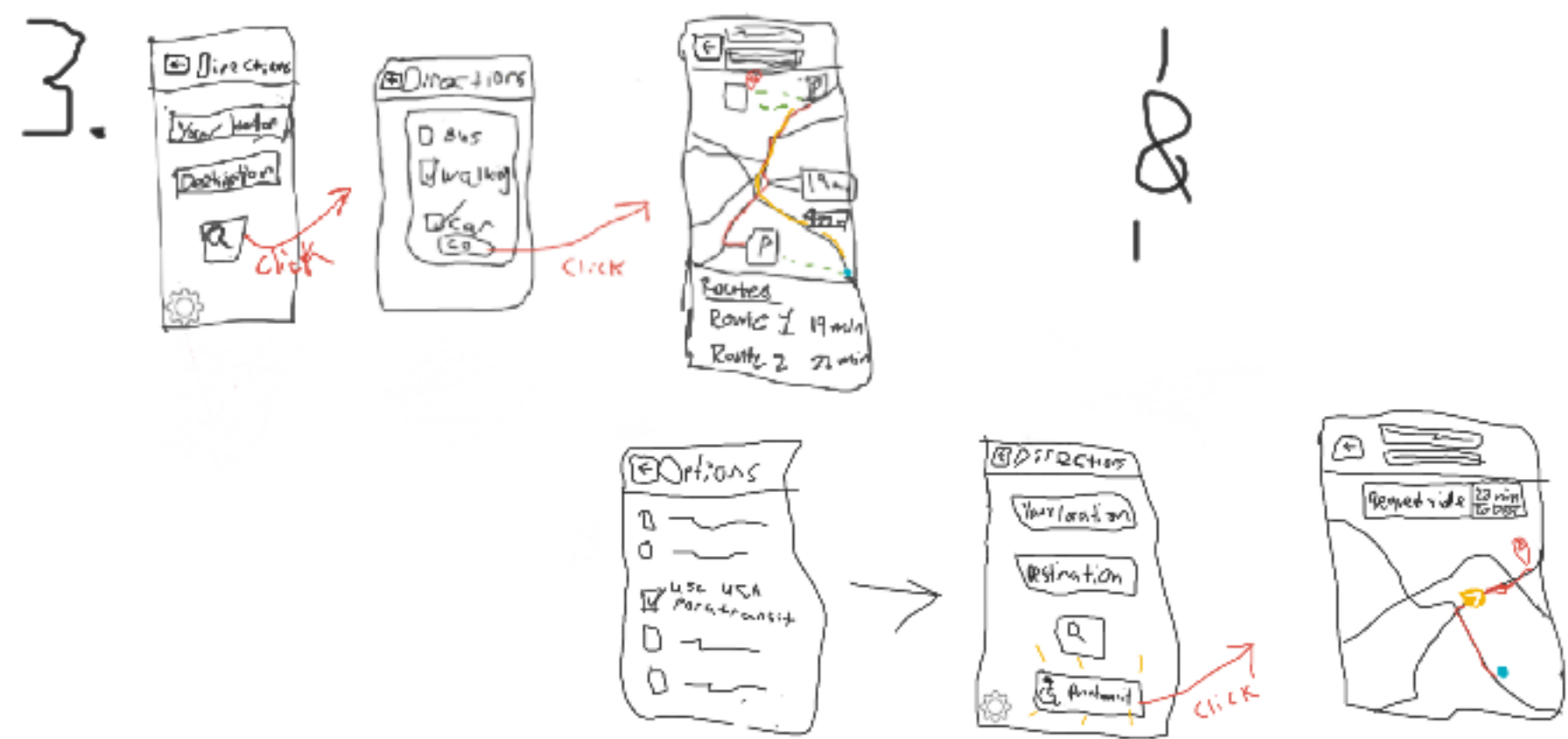
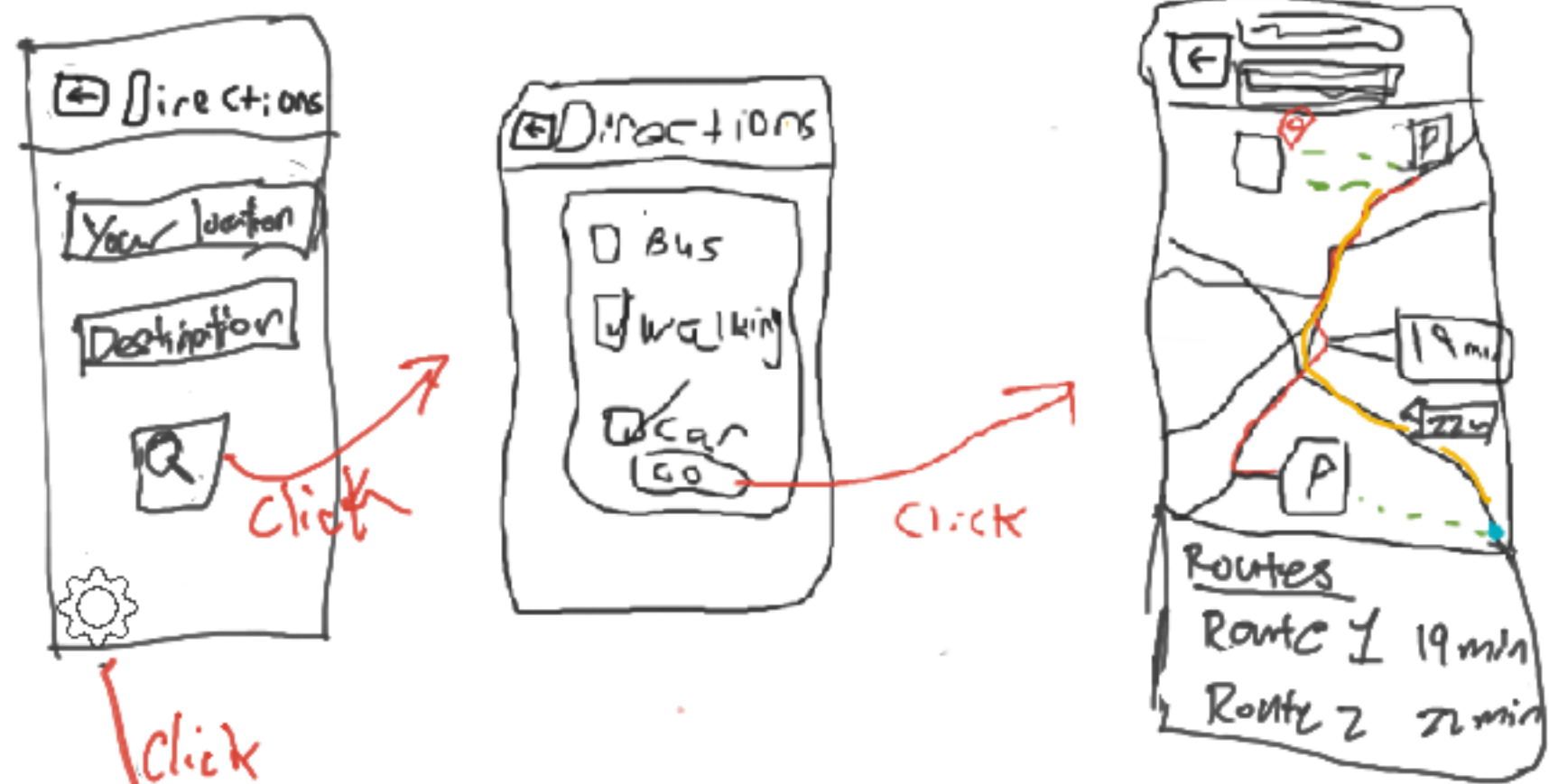

User Story 7:

As a student or faculty member of the university, I want step-by-step directions so that I can easily navigate to a given destination using whichever route I select.

Top Ideas

1.
Step by step directions from current location to a given location.

2.
If on bus, tell me the number of stops until I need to get off

3. 
A combination of ideas 1 and 2

I want the directions to update as I go (from this point onwards)

AR system that shows where to go

I want a dot with an arrow so that I can go in the right direction

Display a line on a map to guide the user

Display turn by turn direction for walking

Tells me the street name that I should go to

Have the directions stay consistent once the user begin navigation

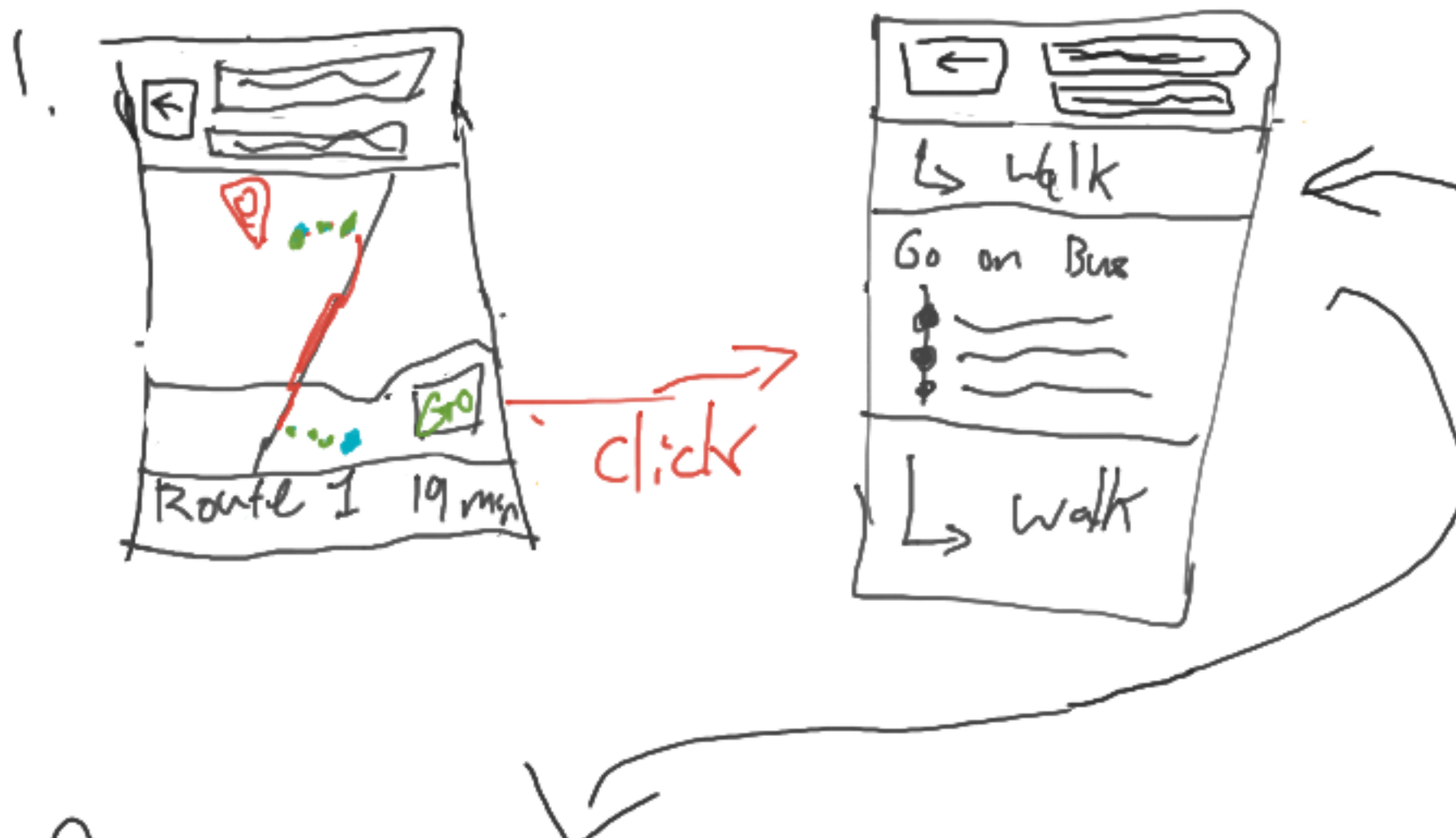

User Story 8:

As a student at the university, I want to connect my Athena & UGA MyID accounts so that I can better keep track of my daily route based on my specific classes.

Top Ideas

1. 
Automatically show buildings that my classes are in on the map.

2. 
Show a timeline of all my classes from my schedule

See on a map where the user's class is for

See potential classes in order for students to determine if travel between classes in time is viable

Show class locations and time until classes starts on map at all times

Login with QR code

Show time until class end

Show time until classes start

Attach account to a specific device using Athena (also able to revoke access for devices)

I want to see the building name and room number for my classes

Sign in through the normal UGA SSO system

Allow for multiple accounts to connect so you can more easily schedule group meetings

How Page



Click

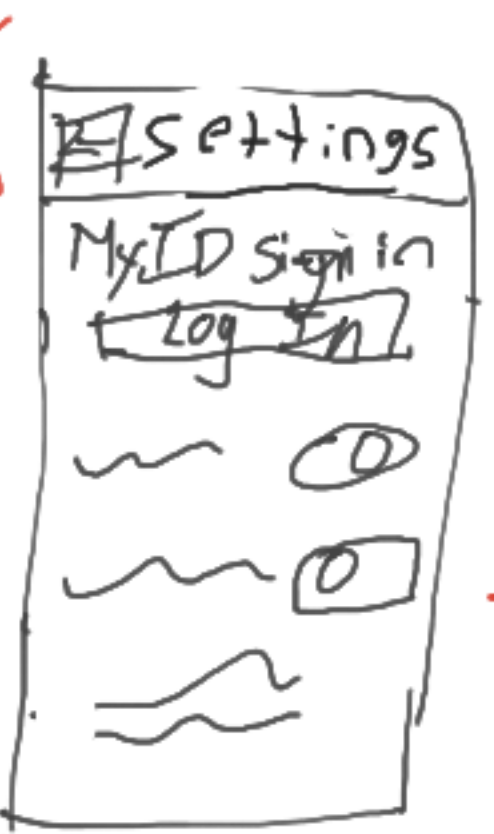

After sign in
in Maps

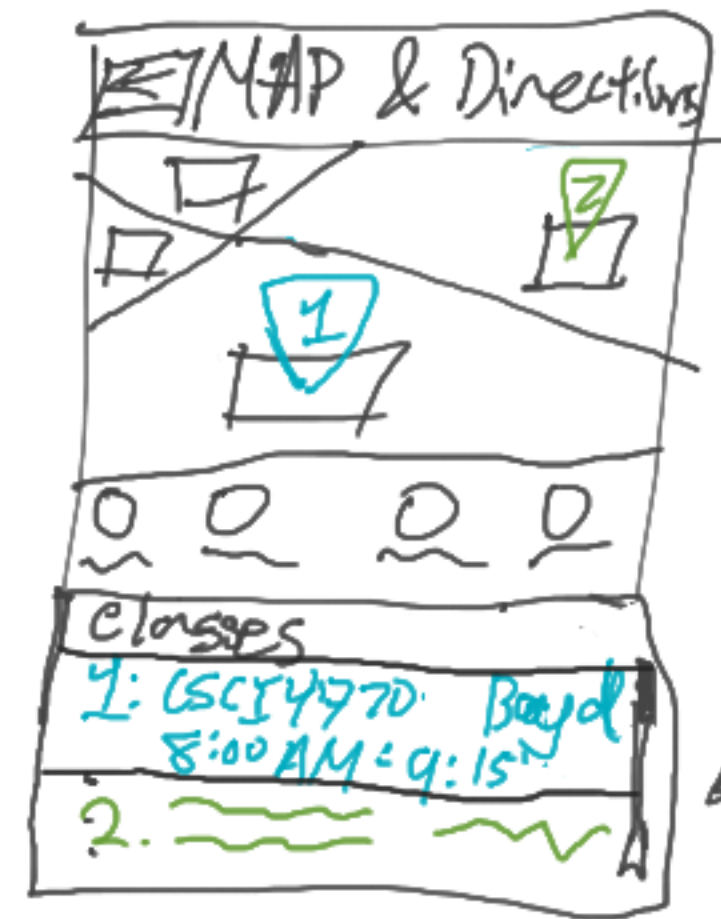

Automatically
update
based on
day of week

2.

Click
before sign in



Click
After
Sign in

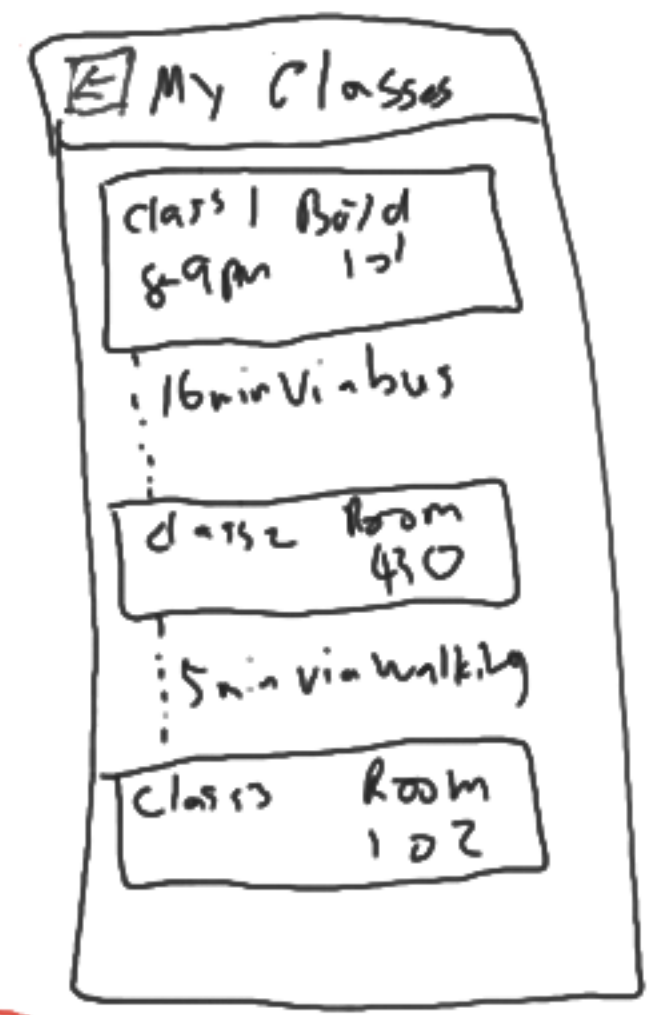

User Story 9:

As a student at the university, I want directions to get to my specific classes based on my class schedule so that I can get to my next class as efficiently as possible.

Top Ideas

1. When a user clicks on a class they are given the option to route directly from their current location to the location of that class.

2. On the user's timeline of classes, they are able to click on one of their classes to be given directions to get to that specific class..

Tells me whether I should walk to my next class or wait for the bus

Allows you to see optimal path with/without taking the bus (same for driving)

Directions not only for next class but the class afterwards as well

Tells what the most optimal combination of driving and bus riding is

Shows the time it takes to get to class using the optimal route

Tells if the most optimal route to my destination is a combination of different bus routes.

Predicts if the user can get to their next class on time and shows the user's ETA

If there's a timeline of my classes, bring me to a page that shows when I will arrive to my next class for different modes of travel

1.



click



2.

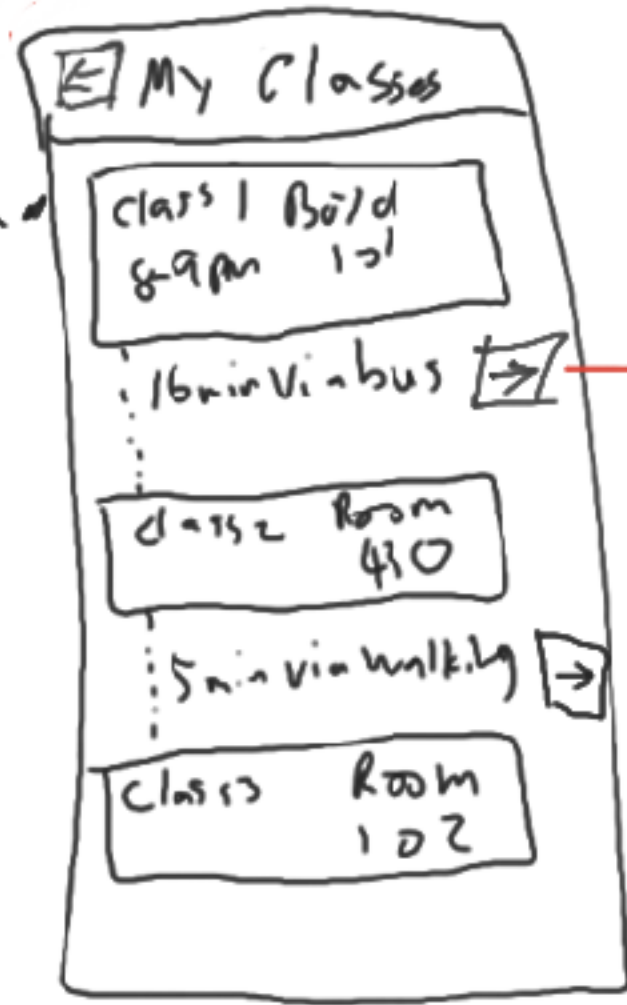

click

